



Pemberton Court
Ingatestone Essex CM4 0TQ
£245,000

Pemberton Court, Ingatestone, Essex CM4 0TQ

A well located first floor apartment situated within walking distance of Ingatestone Railway Station & High Street and offering allocated parking and communal gardens.

Accommodation comprises entrance hall, lounge/diner, kitchen, bathroom, and two double bedrooms.



ENTRANCE HALL

LOUNGE/DINER

14'9 x 11'5 (4.50m x 3.48m)

KITCHEN

14'10 x 6'7 (4.52m x 2.01m)

BEDROOM ONE

11'7 x 10'1 (3.53m x 3.07m)

BEDROOM TWO

13'3 10'0 x 8'2 (4.04m 3.05m x 2.49m)

BATHROOM

COMMUNAL GARDEN

ALLOCATED PARKING

LEASE / SERVICE CHARGES

959 Years remaining on lease.

Service charge currently £680 per annum.



Approximate Gross Internal Area
602 sq ft / 55.9 sq m

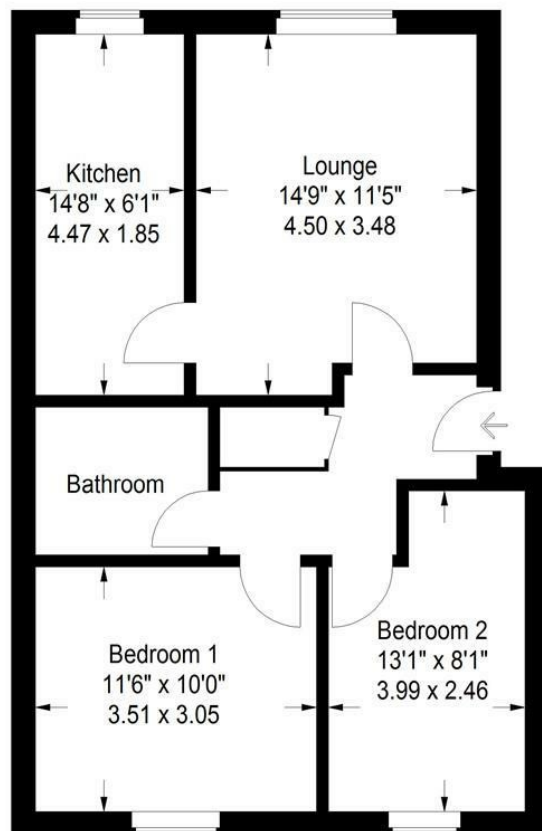

Illustration for identification purposes only,
measurements are approximate, not to scale.
FloorplansUsketch.com © 2017 (ID381201)



Energy Efficiency Rating		
	Current	Potential
Very energy efficient - lower running costs		
(92 plus) A		
(81-91) B		
(69-80) C		
(55-68) D		
(39-54) E		
(21-38) F		
(1-20) G		
Not energy efficient - higher running costs		
England & Wales	EU Directive 2002/91/EC	75

Environmental Impact (CO ₂) Rating		
	Current	Potential
Very environmentally friendly - lower CO ₂ emissions		
(92 plus) A		
(81-91) B		
(69-80) C		
(55-68) D		
(39-54) E		
(21-38) F		
(1-20) G		
Not environmentally friendly - higher CO ₂ emissions		
England & Wales	EU Directive 2002/91/EC	66 68

PLEASE CALL 01277 355005 TO ARRANGE A VIEWING

www.walksestates.co.uk

INDEPENDENT ESTATE AGENTS - VALUATIONS WITH NO OBLIGATION – PROFESSIONAL SERVICE

These particulars do not constitute, nor constitute any part of an offer or contract. All measurements are given as a guide, no liability can be accepted for any errors arising therefrom. No responsibility is taken for any other error, omission, or mis-statement in these particulars. Walkers Village & Country Homes Limited do not make or give, whether in these particulars, during negotiations or otherwise, any representation whatsoever in relation to this property.

